

Course &c down y<sup>e</sup> River

N<sup>o</sup> 69<sup>th</sup> W 31<sup>st</sup> E<sup>s</sup>

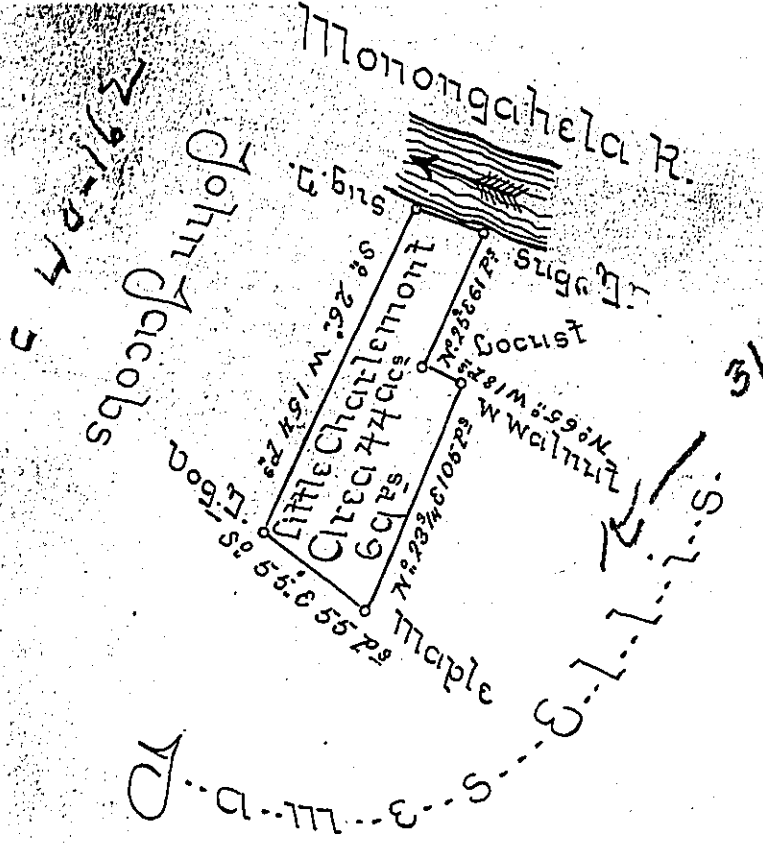

A Draught of a Survey called "Little Charlemont" Sit-  
 uate on the Monongahela River in Washington County  
 cont<sup>g</sup> 4400<sup>ac</sup> 69<sup>th</sup> W 31<sup>st</sup> E<sup>s</sup> strict Measure executed June y<sup>e</sup> 10<sup>th</sup>  
 1786 in Consequence of a Certif<sup>ic</sup> for 400<sup>ac</sup> granted  
 to Jas<sup>es</sup> Ellis by the Commiss<sup>rs</sup> Appointed by Virg<sup>a</sup>  
 to adjust the Claims to unpatented Lands in Mon-  
 onga<sup>a</sup> York<sup>a</sup> & Ohio and duly entered with the Co-  
 munity Surveyor as appears from the List of En-  
 tries transmitted from the Surveyor Generals  
 Office

Ent<sup>d</sup> 20<sup>th</sup> Apr<sup>il</sup> 80

Presley Newill

D.S.S.

ret<sup>d</sup> 18<sup>th</sup> Jan<sup>uary</sup> 87

Mat<sup>thew</sup> Ritchie

J<sup>ohn</sup> S. Smith Esq<sup>ue</sup> S<sup>urveyor</sup>

IN TESTIMONY that the above is a copy of the original remaining on file in  
 the Department of Internal Affairs of Pennsylvania, made  
 conformably to an Act of Assembly approved the 16th day of  
 February, 1833, I have hereunto set my Hand and caused  
 the Seal of said Department to be affixed at Harrisburg,  
 this eight day of October 1904.

*Grace R. Brown*  
 Secretary of Internal Affairs.